

18-24 AWG IDC WIRE TO BOARD CONNECTOR



00-9176-002-001-006

PREFIX

SERIES

NO. OF WAYS

CODE	NO. OF WAYS
002	2
003	3

WIRE GAUGE SIZE

CODE	ACCEPTED WIRE GAUGE	WIRE INSULATION ϕ
001	18 GAUGE STRANDED	ϕ 1.6-2.1
011	20 GAUGE STRANDED	ϕ 1.6-2.1
022	22 GAUGE STRANDED	ϕ 1.1-1.6
032	24 GAUGE STRANDED	ϕ 1.1-1.6

PLATING OPTION

CODE	DESCRIPTION
006	PURE TIN ALL OVER

ELCO EUROPE (A DIVISION OF AVX LTD.) CONFIDENTIAL PROPRIETARY
 THE DRAWING ON THIS PRINT AND INFORMATION THEREWITH ARE
 PROPRIETARY TO ELCO EUROPE (A DIVISION OF AVX LTD.) AND
 SHALL NOT BE USED OR DISCLOSED IN WHOLE OR IN PART
 WITHOUT ELCO EUROPE'S WRITTEN CONSENT.

FORM-106-01-056-6 ISS-7
 Release No.
 History
 102417

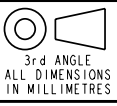

Drawn
GKJ
 Size
CV

Description
 18-24AWG IDC WIRE TO BOARD CONNECTOR
 Part Number
 00-9176-01-000S

DATE
 10-May-07
 Issue
F

18-24 AWG 2 WAY IDC CONNECTOR

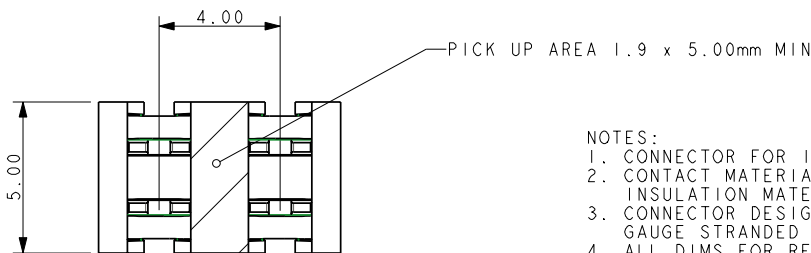

- NOTES:
- CONNECTOR FOR IDC WIRE TO BOARD CONNECTION.
 - CONTACT MATERIAL : PHOSPHORE BRONZE.
INSULATION MATERIAL: HIGH TEMP NYLON 46.
 - CONNECTOR DESIGNED TO ACCEPT BETWEEN 24 AND 18 GAUGE STRANDED WIRE.
 - ALL DIMS FOR REFERENCE UNLESS OTHERWISE STATED.
 - FOR FULL PRODUCT SPECIFICATION REFER TO ELCO SPEC 201-01-106.

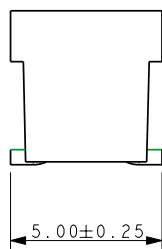
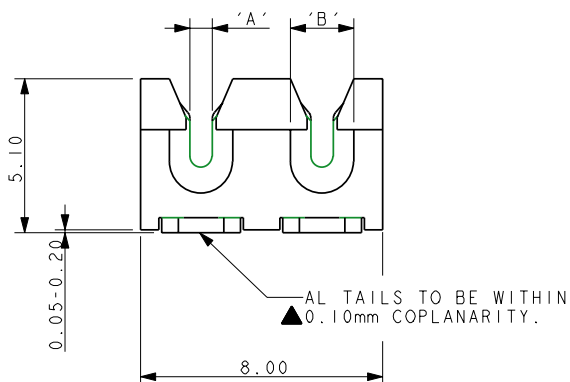

CODE	ACCEPTED WIRE GAUGE	'A'	WIRE INSULATION	'B'
001	18 GAUGE STRANDED	0.72	∅ 1.6-2.1	2.1
011	20 GAUGE STRANDED	0.60	∅ 1.6-2.1	2.1
022	22 GAUGE STRANDED	0.47	∅ 1.1-1.6	1.6
032	24 GAUGE STRANDED	0.37	∅ 1.1-1.6	1.6

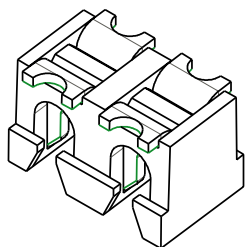
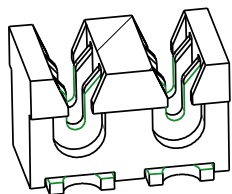

SMT PCB LAYOUT

PURE TIN PADS

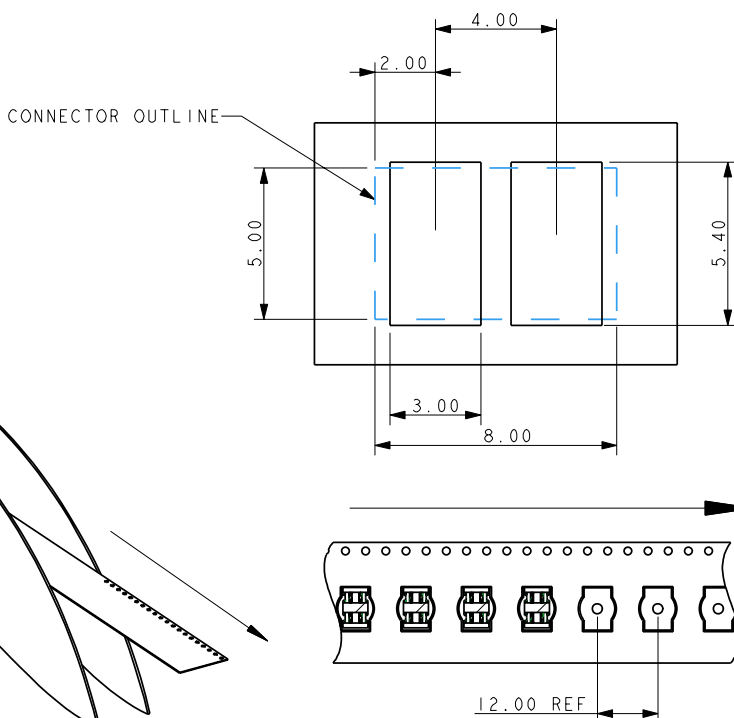

PACKING DETAILS

REEL QTY	1000
LEADER	480mm
TRAILER	120mm
REEL/BOX	5
PACK QTY	5000

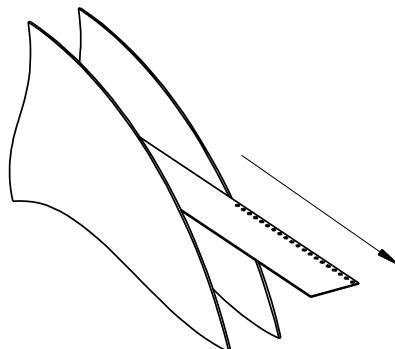

ELCO EUROPE (A DIVISION OF AVX LTD.) CONFIDENTIAL PROPRIETARY
THE DRAWING ON THIS PRINT AND INFORMATION THEREWITH ARE
PROPRIETARY TO ELCO EUROPE (A DIVISION OF AVX LTD.) AND
SHALL NOT BE USED OR DISCLOSED IN WHOLE OR IN PART
WITHOUT ELCO EUROPE'S WRITTEN CONSENT.

Release No.
History
102417

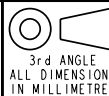

ELCO

© COPYRIGHT ELCO EUROPE
NOT TO BE DISCLOSED OR COPIED
WITHOUT WRITTEN PERMISSION

Drawn
GKJ

Size
CV

Description
18-24AWG IDC WIRE TO BOARD CONNECTOR

Part Number
00-9176-01-000S

DATE
10-May-07

Issue
F

18-24 AWG 3 WAY IDC CONNECTOR

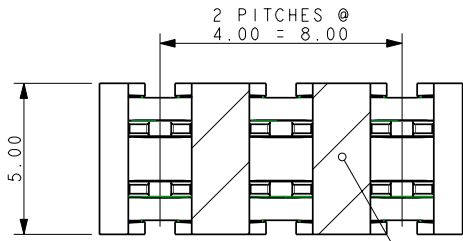

- NOTES:
- CONNECTOR FOR IDC WIRE TO BOARD CONNECTION.
 - CONTACT MATERIAL : PHOSPHORE BRONZE.
INSULATION MATERIAL: HIGH TEMP NYLON 46.
 - CONNECTOR DESIGNED TO ACCEPT BETWEEN 24 AND 18 GAUGE STRANDED WIRE.
 - ALL DIMS FOR REFERENCE UNLESS OTHERWISE STATED.
 - FOR FULL PRODUCT SPECIFICATION REFER TO ELCO SPEC 201-01-106.

PICK UP AREA 1.90 x 5.00mm MIN

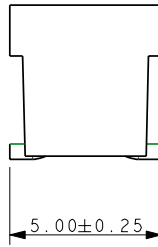
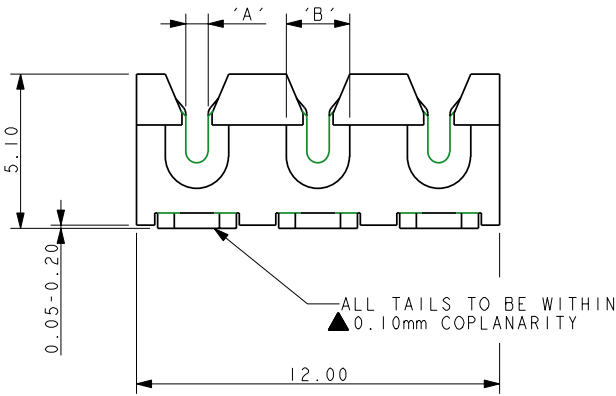

CODE	ACCEPTED WIRE GAUGE	'A'	WIRE INSULATION	'B'
001	18 GAUGE STRANDED	0.72	∅1.6-2.1	2.1
011	20 GAUGE STRANDED	0.60	∅1.6-2.1	2.1
022	22 GAUGE STRANDED	0.47	∅1.1-1.6	1.6
032	24 GAUGE STRANDED	0.37	∅1.1-1.6	1.6

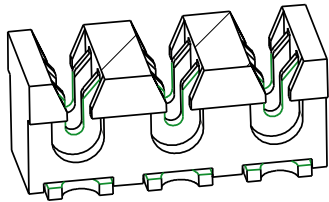

SMT PCB LAYOUT

PURE TIN PADS

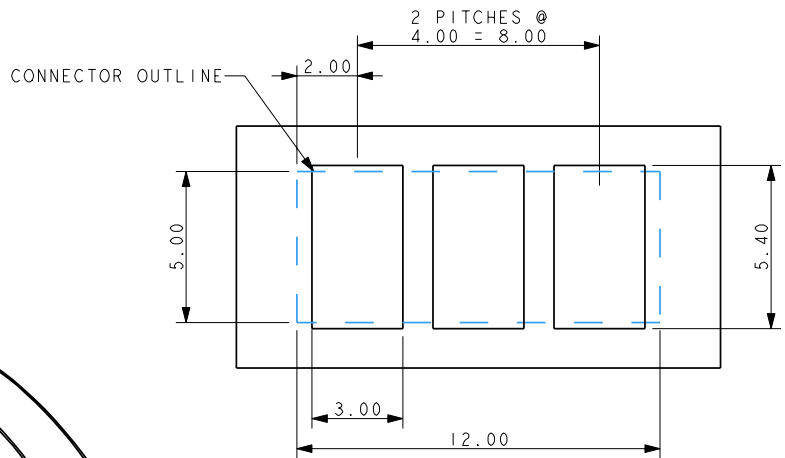

PACKING DETAILS

REEL QTY	1000
LEADER	480mm
TRAILER	120mm
REEL/BOX	5
PACK QTY	5000

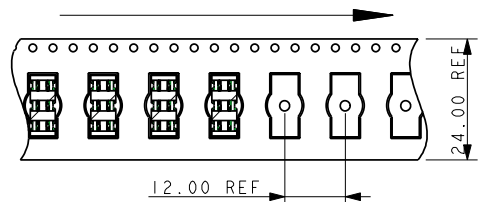
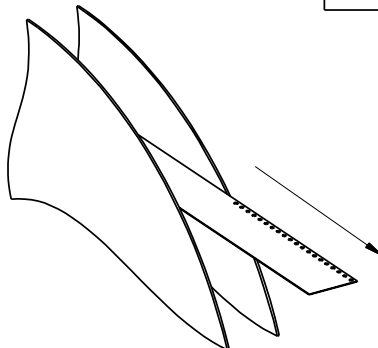

ELCO EUROPE (A DIVISION OF AVX LTD.) CONFIDENTIAL PROPRIETARY
THE DRAWING ON THIS PRINT AND INFORMATION THEREWITH ARE
PROPRIETARY TO ELCO EUROPE (A DIVISION OF AVX LTD.) AND
SHALL NOT BE USED OR DISCLOSED IN WHOLE OR IN PART
WITHOUT ELCO EUROPE'S WRITTEN CONSENT.

Release No.
History
102417



ELCO

© COPYRIGHT ELCO EUROPE
NOT TO BE DISCLOSED OR COPIED
WITHOUT WRITTEN PERMISSION

Drawn
GKJ

Size
CV

Description
18-24AWG IDC WIRE TO BOARD CONNECTOR

Part Number
00-9176-01-000S

DATE
10-May-07

Issue
F

A

I

B

HAND INSERTION TOOLING

FOR SINGLE 18/24 GAUGE WIRE

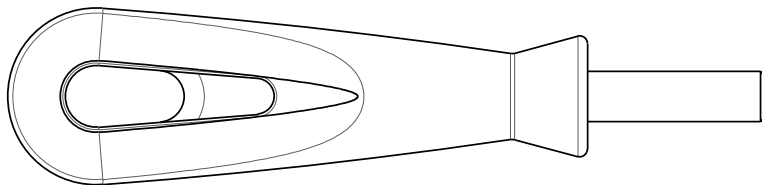

UNIVERSAL HANDLE

DETAILS	TOOL PART NUMBER
6.35 A/F HEX BIT HOLDER	06-7000-7730-01-000

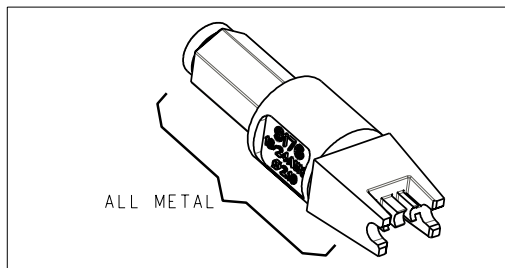

HIGH PRODUCTION METAL

MAX INSULATION DIA	TOOL PART NUMBER
Ø 2.10	06-9176-7017-01-000
Ø 1.60	06-9176-7017-02-000

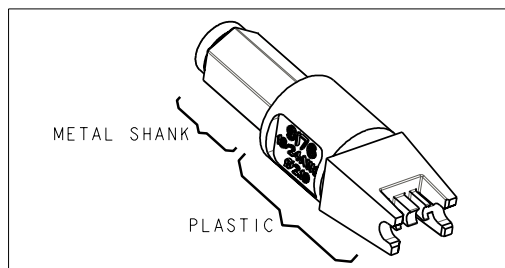

MED PRODUCTION METAL/PLASTIC

MAX INSULATION DIA	TOOL PART NUMBER
Ø 2.10	06-9176-7016-01-000
Ø 1.60	06-9176-7016-02-000

ELCO EUROPE (A DIVISION OF AVX LTD.) CONFIDENTIAL PROPRIETARY
THE DRAWING ON THIS PRINT AND INFORMATION THEREWITH ARE
PROPRIETARY TO ELCO EUROPE (A DIVISION OF AVX LTD.) AND
SHALL NOT BE USED OR DISCLOSED IN WHOLE OR IN PART
WITHOUT ELCO EUROPE'S WRITTEN CONSENT.

Release No.
History
102417

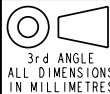

ELCO

© COPYRIGHT ELCO EUROPE
NOT TO BE DISCLOSED OR COPIED
WITHOUT WRITTEN PERMISSION

Drawn
GKJ

Size
CV

Description
WIRE INSERTION TOOL

Part Number
00-9176-01-000S

DATE
10-May-07

Issue
F

FORM-106-01-056-6 ISS-7

A

I

B